

HAMPSHIRE COUNTY COUNCIL

477400

477600

Greatham

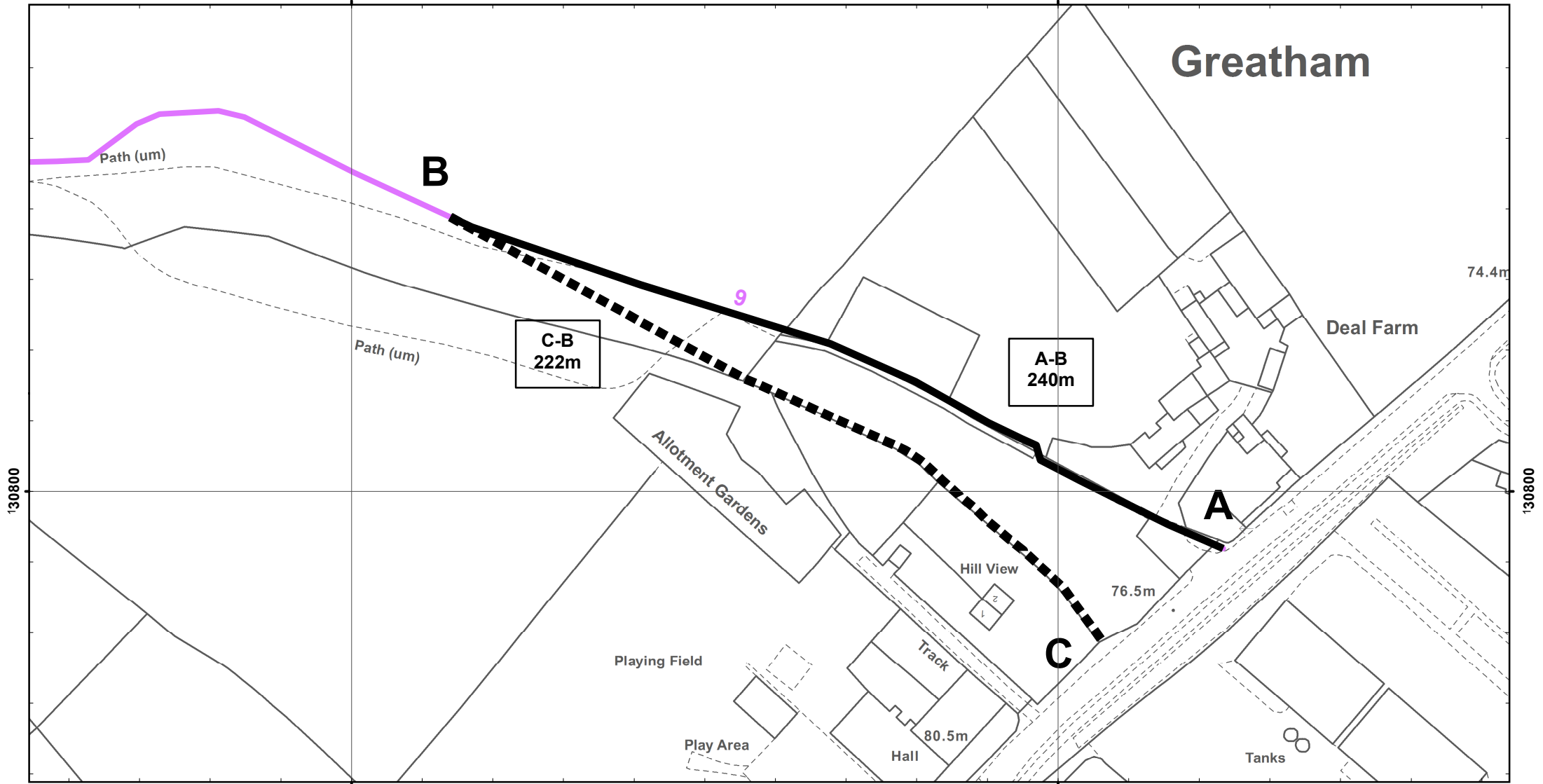

477400

477600

SCALE 1:1500
LEGEND

- FOOTPATH TO BE DELETED:-
- FOOTPATH TO BE ADDED TO THE MAP:-
- EXISTING FOOTPATH TO BE RETAINED:-

MAP No.1660 PRODUCED FROM DIGITAL DATA SUPPLIED BY ORDNANCE SURVEY

THE COMMON SEAL OF HAMPSHIRE COUNTY COUNCIL WAS HEREUNTO AFFIXED IN THE PRESENCE OF:-

.....AUTHORISED SIGNATORY

 DATE.....

REPRODUCED FROM THE O.S. MAPPING WITH THE PERMISSION OF THE CONTROLLER OF HMSO © CROWN. UNAUTHORISED REPRODUCTION INFRINGES © CROWN AND MAY LEAD TO PROSECUTION OR CIVIL PROCEEDINGS. HCC LICENCE No.100019180 DATE (30.10.18)

KAREN MURRAY,
 DIRECTOR OF CULTURE, COMMUNITIES AND BUSINESS SERVICES, WINCHESTER