

- NOTES**
- DO NOT SCALE FROM THIS DRAWING
 - ALL DIMENSIONS IN METRES UNLESS OTHERWISE STATED
 - ALL LEVELS ARE ABOVE ORDNANCE DATUM, UNLESS OTHERWISE STATED
 - ALL WORKS ARE TO BE CARRIED OUT IN ACCORDANCE WITH THE SPECIFICATION FOR HIGHWAYS WORKS (SHW), SUPPLEMENTED BY THE CONTRACT SPECIFICATION APPENDICES
 - REFER TO SERIES 700 DRAWINGS FOR DETAILS OF CARRIAGEWAY CONSTRUCTION.
 - FULL DEPTH CONSTRUCTION
45mm SURFACE COURSE (HRA 30/14 F SURF 40/60)
60mm BINDER COURSE (AC20 DENSE BIN 40/60)
180mm BASE (AC32 DENSE BASE 40/60)
145mm GRANULAR TYPE 1 SUB-BASE
600mm 6F5 CAPPING
 - SURFACE COURSE INLAY
45mm SURFACE COURSE (HRA 30/14 F SURF 40/60)
 - EXISTING DRAINAGE NETWORK IS TO BE CLEANSED AND JETTED ONCE THE WORKS ARE COMPLETE
- KEY**
- PG# PROPOSED TYPE 1 GULLY TO STANDARD DETAIL HCC10/D/015 WITH REFERENCE
 - PC1 PROPOSED TYPE PC1 PRECAST CONCRETE KERB TO STANDARD DETAIL HCC10/C/010
 - PROPOSED FULL DEPTH CARRIAGEWAY CONSTRUCTION SEE NOTE 6
 - PROPOSED CARRIAGEWAY INLAY RESURFACING TO A DEPTH OF 45mm MAX SEE NOTE 7
 - PROPOSED GULLY CONNECTION PIPE WITH FLOW DIRECTION
 - PROPOSED WHITE COLOURED ROAD MARKING WITH DIAGRAM NUMBER AND WIDTH IN MILLIMETRES OR LENGTH INDICATED IN BRACKETS
 - PS# RELOCATED ILLUMINATED TRAFFIC SIGN ON NEW WBP POST WITH REFERENCE
 - HIGHWAY BOUNDARY
 - PROPOSED TOPSOIL AND SEEDING

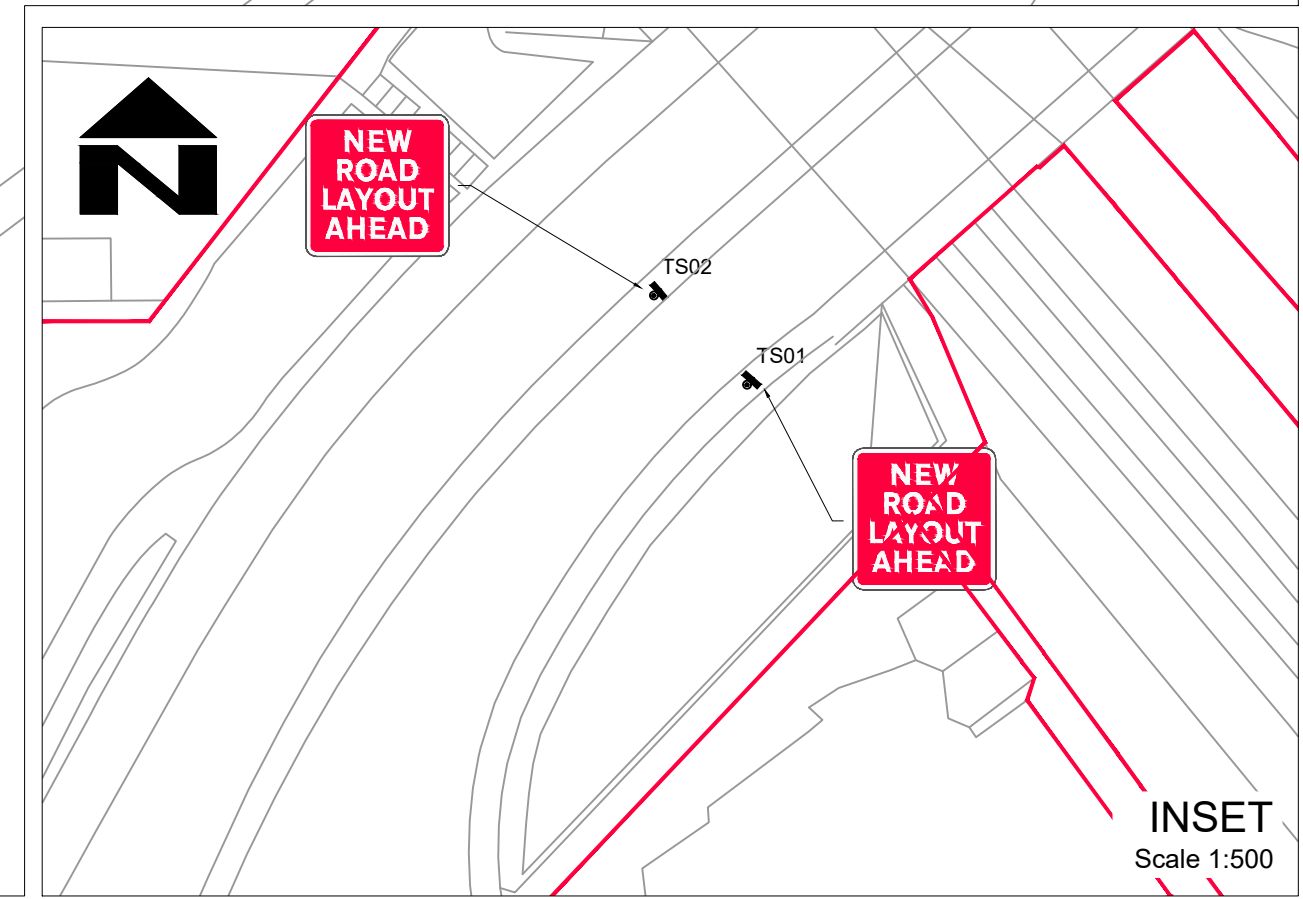

© CROWN COPYRIGHT AND DATABASE RIGHTS 2019
ORDNANCE SURVEY 100019180

CLIENT HAMPSHIRE COUNTY COUNCIL ECONOMY, TRANSPORT AND ENVIRONMENT DEPARTMENT STRATEGIC TRANSPORT				CONSULTANT STUART JARVIS BSc DipTP FCIHT MRTPI: DIRECTOR OF ECONOMY, TRANSPORT & ENVIRONMENT				DESIGNER MF CAD CLT CHECKED JEMR APPROVED JRO				SCHEME BRADFORD ROUNDABOUT FARNBOROUGH JOB No. C.J008996.01 SCALE @ A1 1:200 DATE 27.03.2019 SHEET NUMBER 1 OF 1				DRAWING TITLE GENERAL ARRANGEMENT HCC CAD PLOT: 218/2019 12:26:46 DRAWING NUMBER EC/CJ008996/101 REV A			
AMENDMENTS REV DATE CAD CHKD APPD																			