

APPENDIX 2

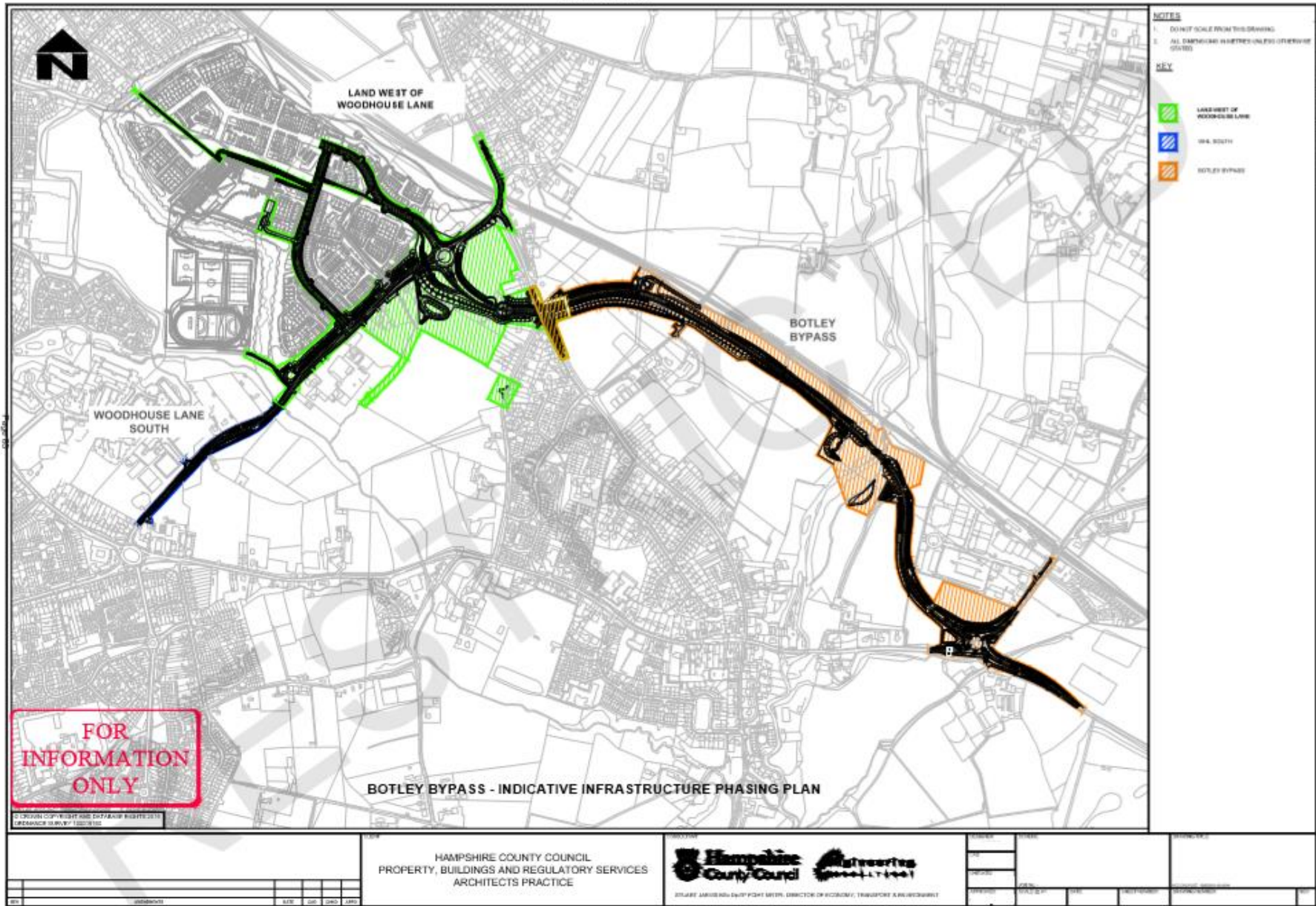

- NOTES**
- DO NOT SCALE FROM THIS DRAWING
 - ALL DIMENSIONS IN METRES UNLESS OTHERWISE STATED
- KEY**
- LAND WEST OF WOODHOUSE LANE
 - WAL SOUTH
 - BOTLEY BYPASS

© CROWN COPYRIGHT AND EXPANDED RIGHTS 2011
 LINDA MACE SURVEY 1201/0102

HAMPSHIRE COUNTY COUNCIL
 PROPERTY, BUILDINGS AND REGULATORY SERVICES
 ARCHITECTS PRACTICE

Hampshire County Council **Architects Practice**

ALAN JAMES HILL EQUIPMENT SERVICES, DIRECTOR OF ECONOMIC, TRANSPORT & INFRASTRUCTURE

NO.	DATE	BY	REVISION