

General Notes

1. This drawing is © copyright Hampshire County Council 2017. No unauthorised reproduction of any kind is permitted.
2. No dimensions to be scaled from this drawing. Verify all dimensions prior to construction. Immediately report any discrepancies on the document to the Architect/Contract Administrator. This document shall be read in conjunction with associated models, specifications and related consultant's documents.
3. Drawing to be read with all relevant Structural, M&E, Public Health, Landscape, Civils and Interiors drawings and specifications.
4. This map is reproduced from Ordnance Survey material with the permission of Ordnance Survey on behalf of the controller of Her Majesty's Stationery Office © Crown copyright. Unauthorised reproduction infringes Crown Copyright & may lead to prosecution or civil proceedings (100019180) 2017.

Hampshire County Council

Notes:

- Main Site Compound
- ▨ Temporary compound to form new staff car park
- Site Area
- - - Compound Fence Line

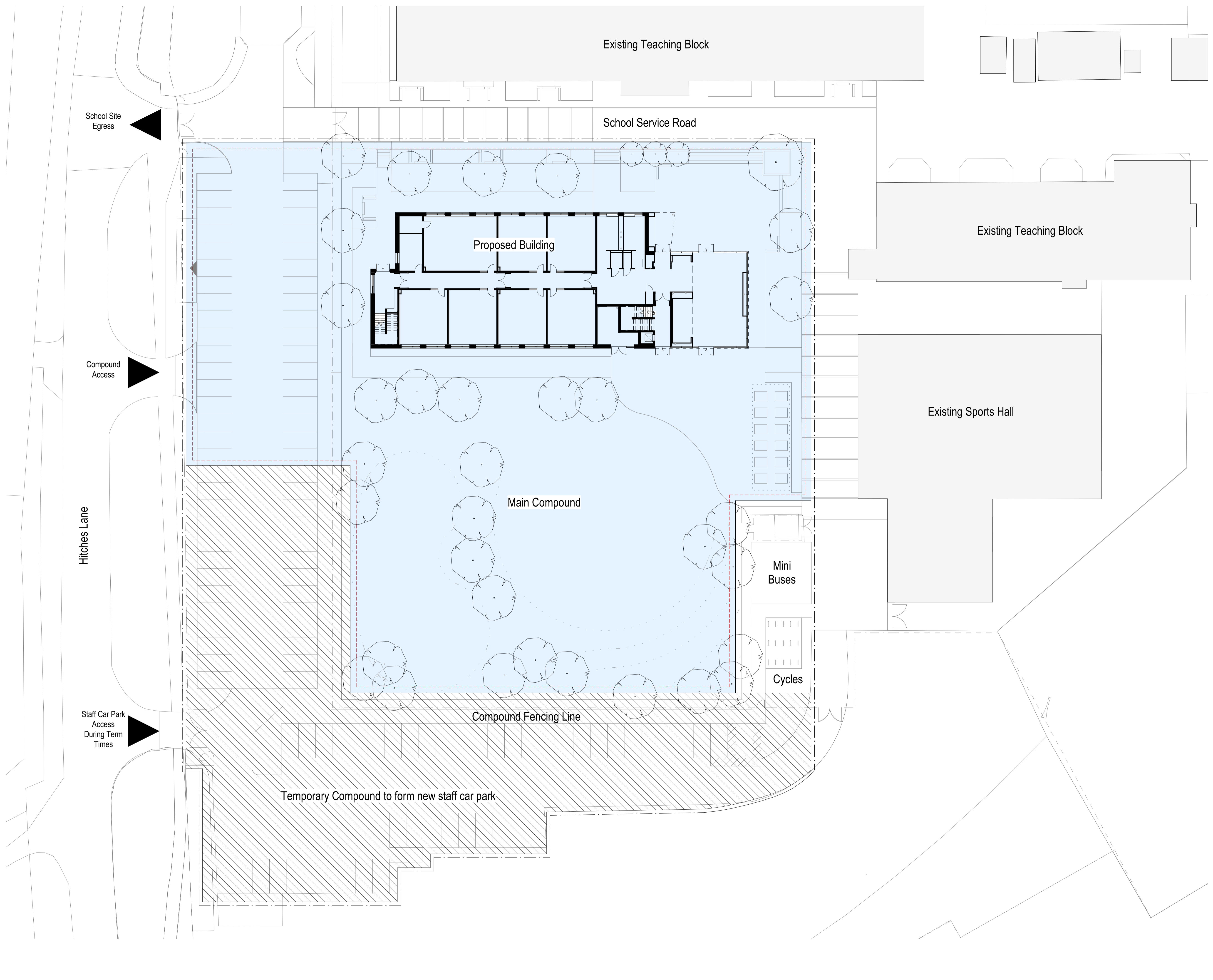

Rev	Description	Date	By	Chkd
P1	Issued For Planning	20.09.19	GR	CG
P2	Issued For Planning - Revision 01	29.01.20	GR	CG

HCC Property Services,
 Three Minsters House,
 76 High Street, Winchester SO23 8UL
 tel: (01962) 847801

HCC
 Property Services

New Building
 Calthorpe Park Secondary School

Site Compound Plan

SCALE
 As indicated @ A1

DRAWN GR
CHKD CG

DRAWING No.
 project code - originator - volume - level - type - role - number revision version
P11866-HCC-NB-00-DR-A-1601 P2

SUITABILITY
 code description
PLANNING